

PRODUCTS



CALENDARED

Sheets, blankets and strips for various applications: abrasion, chemical agents, high voltage, hospital, industrial, oil, telecommunications and others.

Thickness from 0.4 mm to 25 mm, width up to 2,000 mm, and length up to 50.000 mm.

It can be smooth, cross-linked, with or without fabric reinforcement in different elastomers and colors.



PRESSED



Modern compression or transfer presses of different sizes, for molds with a diameter of up to 1,100 mm, shock absorbers, rings, washers, bushings, cushions and any type of parts.

May have inserts made of metal, nylon, fabric and others.
Development according to sample, drawing and specification.



INJECTED



High productivity injection molding machines, with an injection capacity of up to 2,000 mm³ of rubber, a plateau of 600x650 mm, with a multi-point injection system, ensuring greater performance and less loss in the process.



EXTRUDED

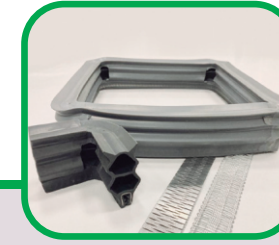

Special profiles, with any geometry in different compounds and colors. For all types of applications and segments, by design, sample or specification. Large profiles, with pieces of diameter up to 260 mm. Profiles with drawn metallic tape insert or Wire Carrier. Continuous vulcanization in a hot air tunnel or vulcanization in an autoclave.



PIPES/HOSES/CONNECTORS

Tubes and hoses for industrial use in various segments. With resistance to high temperatures, fuels, oils and ozone. Hoses for sand blasting, shot blasting, compressed air or other gases. Hoses with or without textile reinforcement, mono or bi elastomers. Spongy or solid tubes in all sizes. Special connectors for the automotive industry, in any shape or specification.



PPE'S - SAFETY MATERIALS

Safety and Protection Materials. Green strip with fabric reinforcement, according to NORMA EB2046/ BBR-11370, for making lanyards. Orange insulating protectors, with or without terminal, according to ANSI/ASTM D-1050-77 STANDARD. Sheet and insulating blanket in orange or pink, according to ANSI/ASTM D-1048 STANDARD.

INFRASTRUCTURE



Office

Tooling

Boiler

Expedition



Maintenance

Quality Control

Warehouse

Laboratory

THE HORIZON it has an alternative source of the main energies; Water, air and electricity.



625 KV generator supplies the entire factory in the event of a power outage.



3 compressors, being that one of them remains in Stand By in the event of maintenance or shutdown.



Artesian well for self-sufficiency of water and supply by the public network in case of maintenance in the well. Supply capacity of 5000 L/H.